

## LED Tri-Proof Linear Luminaire



**Application:** Parking garages; docks; subway station; canopy; walk-in refrigerators; awning...



### Specifications:

Model No.	LED-TRI-4FT-32W-XXK	LED-TRI-8FT-64W-XXK
Power:	32W	64W
Input Voltage:	AC100-277V	
Luminous Flux:	4160	8320
Efficacy:	130 lm/W	
Power Factor:	>0.9	
THD:	<10%	
CCT:	5000K (4000k Option)	
CRI:	>80	
Working Life:	>50,000 hours	
Working Temperature:	-10°F to 105°F	
Protection Level:	Wet Location/IP65	
Product Size:	2.46" x 2.24" x 47.63"	2.46"x2.24"x95.27"
Qty/Pack	10	6
Packing Size:	6.67"x14.96"x52.36"	6.67"x9.45"x99.61"
Net Weight/Pack	30.86 lbs	33.07 lbs

### FEATURES

- IP 65, water tight and dust tight
- Suitable for wet location
- Available in 4 foot and 8 foot
- Aluminum housing for thermal management and polycarbonate lens
- 0-10V Dimmable
- Linkable: 4FT (Max 4pc) & 8FT (Max 3PC)

### Application

- Parking garages; docks; subway station; canopy; walk-in refrigerators; awning
- Indoor and Outdoor Application

### Ordering Guide

**EXAMPLE: LED-TRI-4FT-32W-XXK**

Product	Length	Power	CCT
LED-TRI	4ft or 8ft	4FT = 32W 8FT = 64W	4000K OR 5000K

# DIMENSION

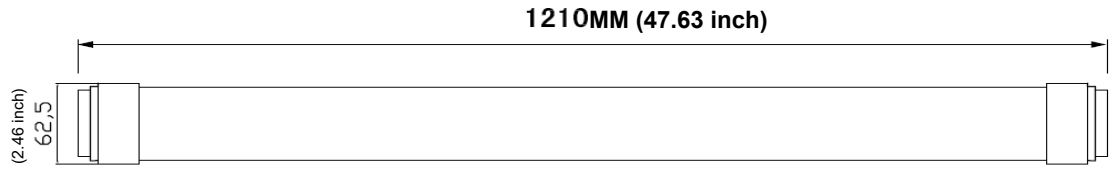
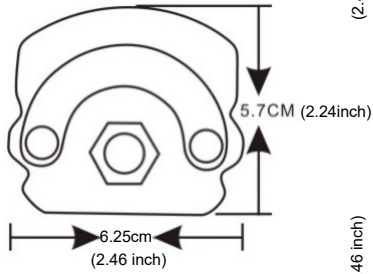

Input voltage: AC120~277V white: N , Black: L , Purple: 0~10V+ , Gray: 0~10V -

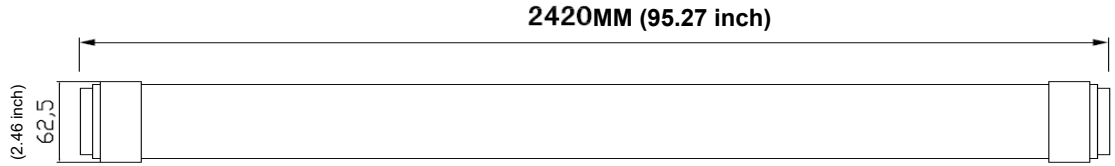

Input voltage: AC120~277V white: N , Black: L , Purple: 0~10V+ , Gray: 0~10V -

# Installation Guide

## Suspending

1. Install the suspension rope

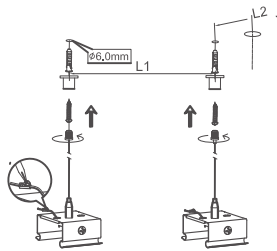

2. push the Lamp body into the mounting clips

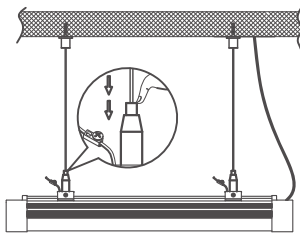

## Surface Mount

- Step 1

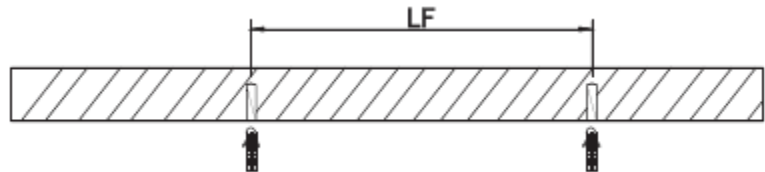

- Step 2

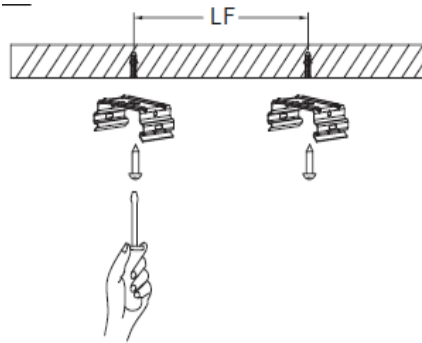

- Step 3

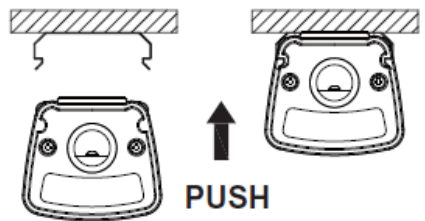

## Connection Installation

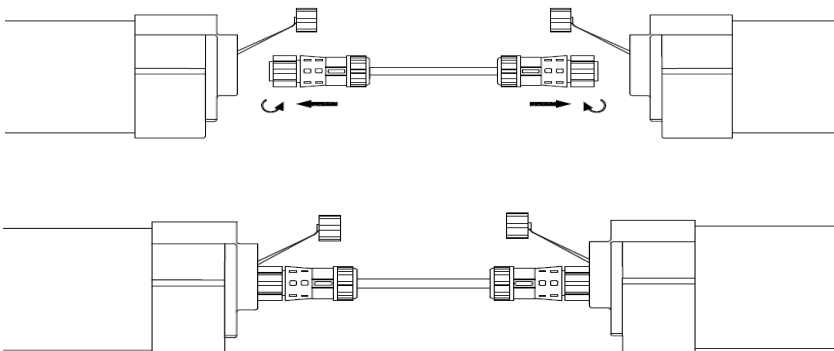

## PHOTOMETRIC REPORT

