

<b>Project:</b>	
<b>Type:</b>	
<b>Catalog #:</b>	

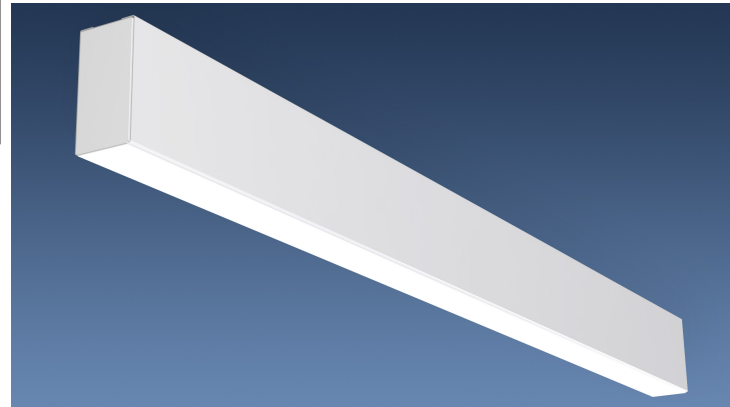

### APPLICATIONS

A linear 3x5 fixture for distinctive architectural lighting plans. Ideal for corridors, lobbies and office areas, 3x5 Series fixtures can be installed individually or in a continuous run. Specifically designed for direct/indirect lighting with snap-in lens to hide the lamps or LED arrays. Ideal where downlight and uplight are required.

### FEATURES & BENEFITS

- ◆ Fixtures can be pendant hung by stem or cable.
- ◆ UL listed for damp locations
- ◆ CRI 80+
- ◆ BAA Compliant



### SPECIFICATIONS

Die-formed and welded 22 gauge cold rolled steel. Knockouts on ends allow continuous wireway mounting. Housing is specially designed for direct/indirect lighting with led's separating compartments for each. 4' and 8' units have a steel mullion to join two individual diffusers. Snap in lens is ideal for uplight.

### ORDERING DATA

EXAMPLE: LP35-46-LED-UD-4480-4480-DMV-WH-30K

LP35 Pendant Mount! LW35 Wall Mount	Length	LED	UD Uplight/Downlight	<u>2FT</u>	Voltage	Finish	Color Temp	Options
	24 24 inch 36 36 inch 46 46 inch 92 92 inch xx custom length			<b>3166-3166 (34W)</b> <b>4350-4350 (48W)</b> <b>5470-5470 (62W)</b> <b>6452-6452 (78W)</b>	<b>DMV</b> 120-277V Multivolt 0-10V Dimmable  <b>D120</b> Triac Dimming 120VAC	<b>WH</b> White <b>xx</b> custom color	<b>30K</b> 3000K <b>35K</b> 3500K <b>40K</b> 4000K <b>50K</b> 5000K	<b>EM5</b> 5w emergency battery back up  <b>EM12</b> 12w emergency battery backup
				<u>4FT</u> <b>3220-3220(34W)</b> <b>4480-4480 (48W)</b> <b>5705-5705 (60W)</b> <b>6910-6910 (74W)</b> <b>8640-8640 (96W)!</b> <b>11797-11797 (140W)</b>				
				<u>8FT</u> <b>3220-3220(34W)</b> <b>4480-4480 (48W)</b> <b>5705-5705 (60W)</b> <b>6910-6910 (74W)</b> <b>8640-8640 (96W))</b> <b>11797-11797 (140W)</b> <b>13820-13820 (156W)</b> <b>17280-17280 (198W)</b> <b>22008-22008 (256W)</b>				
				<b>***Custom lumen packages available please call</b>				

\*\*\*Custom shapes and continuous runs are available please call

**\*\*SPECS SUBJECT TO CHANGE WITHOUT NOTICE**

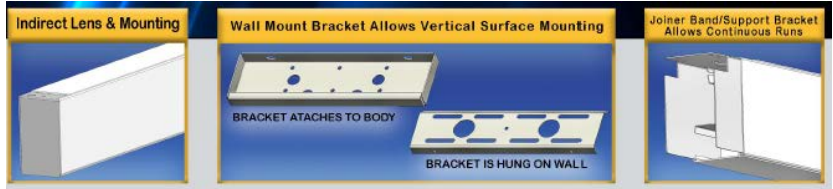

Project:	
Type:	
Catalog #:	

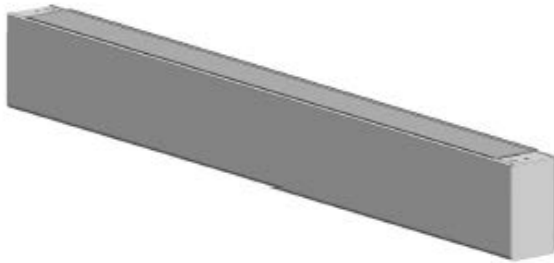

TOP VIEW (UPLIGHT)

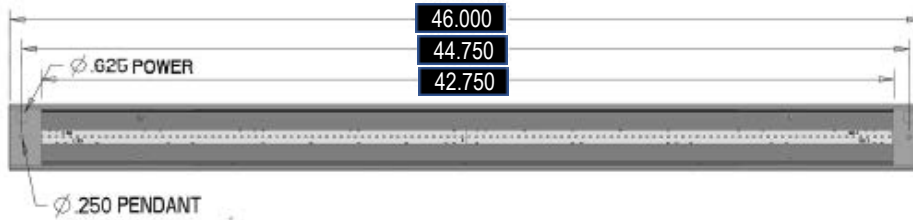

SIDE VIEW

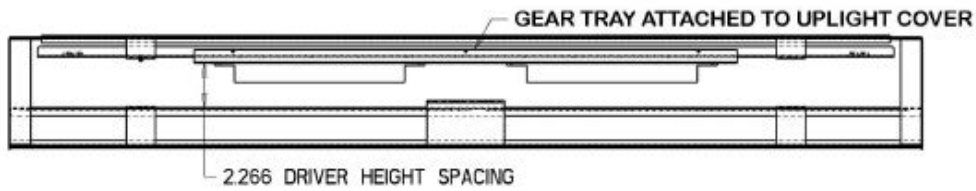

BOTTOM VIEW (DOWNLIGHT)

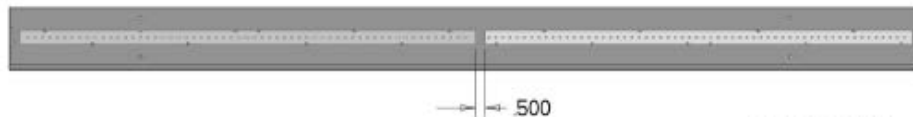

END VIEW

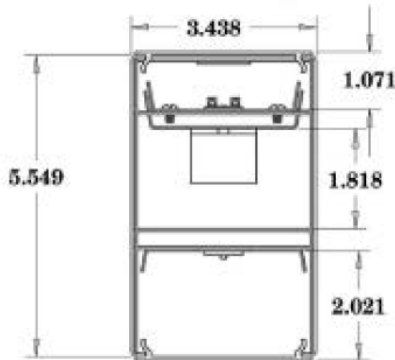

**\*\*SPECS SUBJECT TO CHANGE WITHOUT NOTICE**